

Fitted &
Fully Managed

Discover 52 Jermyn Street

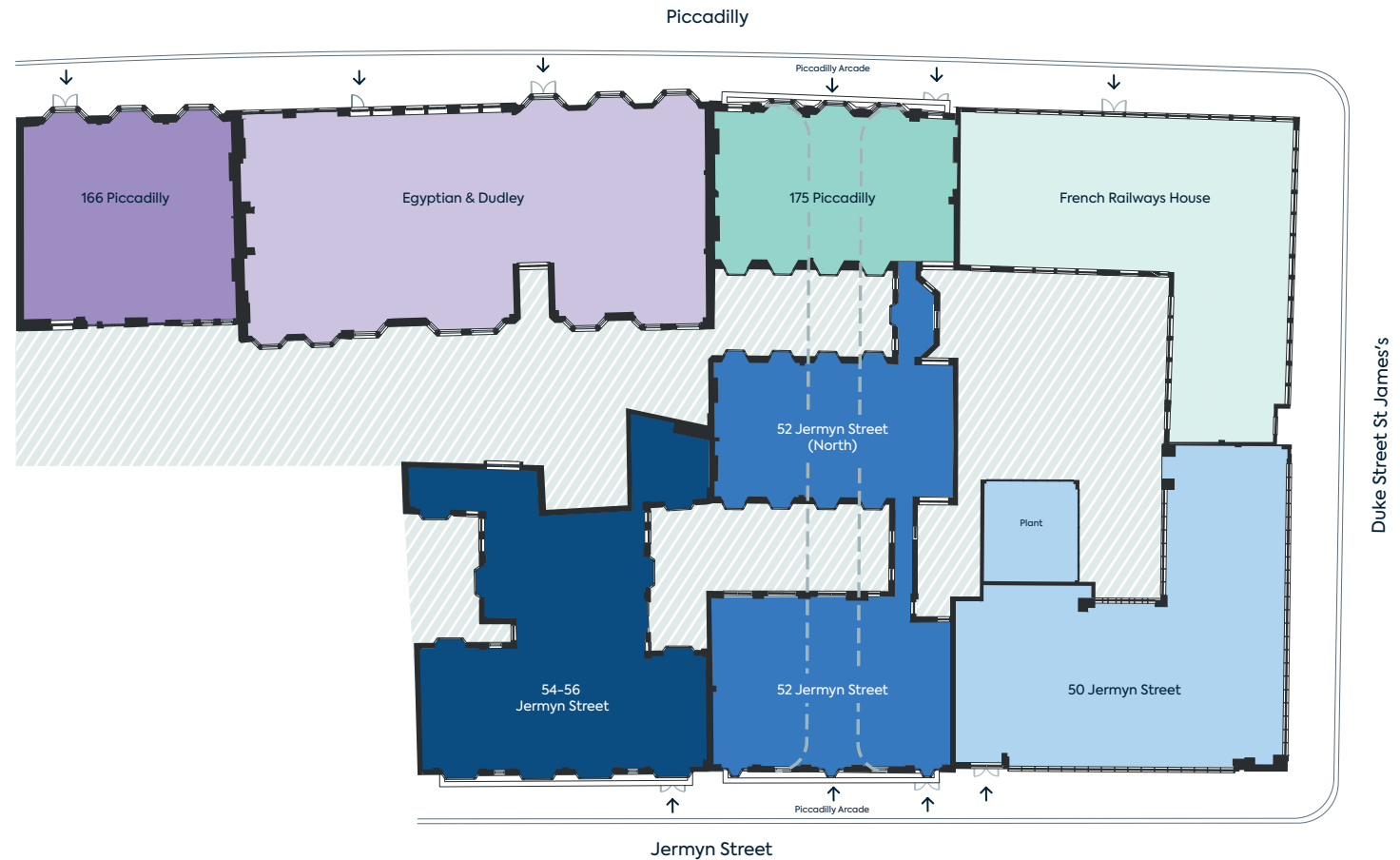

Piccadilly & Jermyn Street Masterplan



- 166 Piccadilly
- Egyptian & Dudley
- 175 Piccadilly
- French Railways House
- 50 Jermyn Street
- 52 Jermyn Street
- 54-56 Jermyn Street
- Pavement
- Roof of ground floor
- Building entrance on ground floor
- Piccadilly Arcade

52 Jermyn Street

52 Jermyn Street, St. James's, London SW1Y 6LX

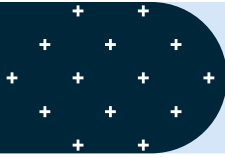

52 Jermyn Street is a modern office development which has been substantially refurbished behind a period facade. The building offers Fitted and Fully Managed work space, ready to move in.

In the heart of St James's, an iconic street steeped in history, 52 Jermyn Street is situated on the north side of Jermyn Street, adjacent to The Piccadilly Arcade, between Duke Street St James's and St James's Street. Green Park and Piccadilly Circus underground stations are within easy walking distance.

Period
façade

Find out more >

The Building



Size:
16,298 sq ft



Secure
cycle spaces



On site
concierge



Shower facilities



sesame, our smart
workplace app,
connects you with your
dedicated Lifestyle
Concierge Service



24 hour access
and security

Specification



Fitted & Fully Managed
workspaces



WCs



1 x 8 person
passenger lifts



Wi-Fi 6 ready for
ultra-fast connectivity



4 pipe fan coil heating
and cooling



Private networks for
private workspaces
(1GB switches, firewall
and flood wired CAT
6 cabling)



What's available?

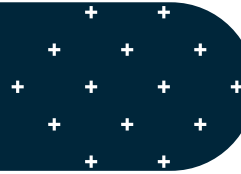

1,600 sq ft of available space at 52 Jermyn Street

Building	Floor	Desks	Max occupancy	Sq ft	Highlight	Availability
52 Jermyn Street (North)	3	21	21	1,600	Direct access to Piccadilly and Jermyn Street	Coming May 2023

52 Jermyn Street (North)

3rd Floor



St. James's



21 total headcount



21 maximum occupancy



1,600 sq ft



Equipped with a secure broadband connection



Coffee machine



Wine Fridge

The Workspace

Desks	21
Hot desks	6
Welcome lounge	1
8 persons meeting room	1
Breakout area	1
Phone pod	1
Kitchen	1
WCs	5

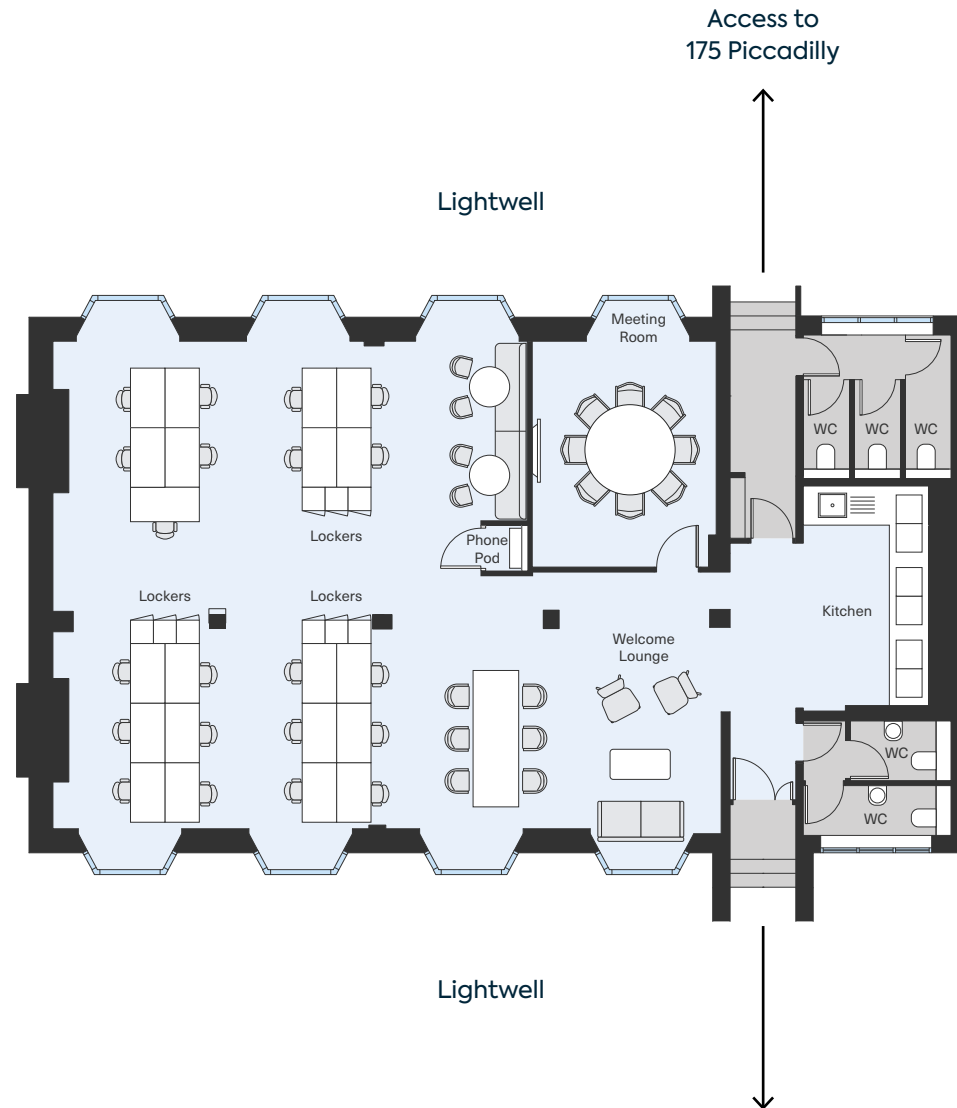



Your own open plan office space



Your own teapoint

Local Area

Connections

The local transport links are superb, with Piccadilly Circus and Green Park underground stations within a few minutes' walk providing direct access to the Piccadilly, Jubilee, Victoria and Bakerloo lines.

Nearby Stations



St James's Park



Sunspel, Jermyn Street



Royal Academy of Arts



Location

The building is ideally located to benefit from the wealth of shops, restaurants, cafés and bars that are available in Mayfair and St James's. Many world renowned luxury hotels are located nearby, including Claridges, Brown's and The Ritz.

Originally built for princes and courtiers, St James's has evolved into one of London's most dynamic districts where centuries of heritage and tradition blend with contemporary luxury and cutting edge style.

St James's has always been fashionable, but now modern art galleries and boutique arcades sit beside the artisan shirt makers and cobblers of old. Cornerstone concepts in modern dining complement established restaurants with over 200 years of history. Traditional shopfronts remain, but behind, the offerings are far from it.

Local Finds

- | | |
|--|---|
| 3 Shopping arcades within a 5 minute walk | 14 Flagship stores within a 10 minute walk |
| 11 Delicatessens within a 10 minute walk | 15 Art galleries within 5 minutes, including the Royal Academy of Arts |

Eat

- 45 Jermyn Street
- Aquavit
- Café Murano
- Cecconi's
- Chutney Mary
- Fortnum and Mason
- Franco's
- Il Vicolo
- Locketts London
- Maison François
- Ole & Steen
- Quaglino's
- Sake No Hana
- Sexy Fish
- The Wolseley
- Wild Honey
- Wilton

Culture

- BAFTA
- Christie's
- Criterion Theatre
- Grosvenor Gallery
- Her Majesty's Theatre
- Institute of Contemporary Arts
- Jermyn Street Theatre
- Martyn Gregory
- Royal Academy of Arts
- Theatre Royal Haymarket
- White Cube Mason's Yard
- Whitford Fine Art

Hotels

- Brown's Hotel
- Le Meridien
- The Cavendish
- The Ritz London
- The Stafford

Private Members Clubs

- Annabel's
- Boodle's
- Naval and Military Club
- Oxford and Cambridge Club
- The Arts Club
- The Athenaeum Club
- The Travellers Club
- White's Club



Sexy Fish, Berkeley Square

Fortnum & Mason



Quaglino's

The Ritz London



Berry Bros & Rudd



Contact our Fitted & Fully Managed team at GPE:

Grace Tomlinson

+44 (0) 7871 678 728

David Korman

+44 (0) 7435 939 956

fittedandmanaged@gpe.co.uk

